





COMET

2U Mono-Glass Module

640W-670W

Technical Features:

-  Partial Shading Optimisation
-  Better Temperature Coefficient
-  High Temperature Restriction
-  Micro-crack Resistance
-  Higher Power
-  Lower BOS
-  More Aesthetic Values



red dot winner 2023



Product Warranty
Extendable to 25years*



Performance Warranty



IEC 61215 IEC 61730
2014/35/EU



Warranty partner

Munich RE 

ISO 9001:2015 ISO 14001:2015 ISO 45001:2018

670W
Output

24.8%
Efficiency

≤1%
First-year Degradation

≤0.35%
Annual Degradation from Year 2-30

30-year Linear Performance Warranty

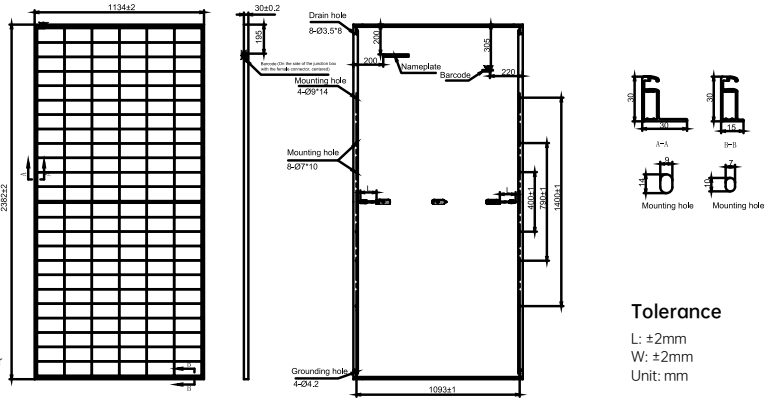
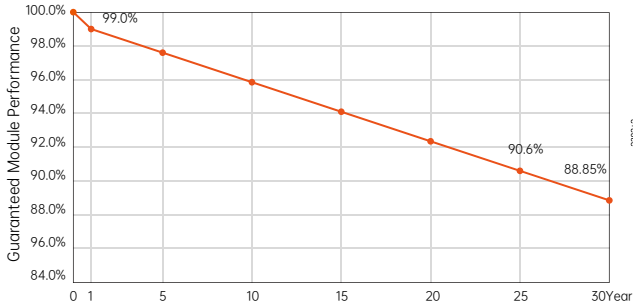

Electrical Characteristics (STC: AM1.5 1000W/m² 25°C NOCT: AM1.5 800W/m² 20°C 1m/s) Power Tolerance: 0~ + 3%

Module Type	AIKO-G640-MCH72Mw		AIKO-G645-MCH72Mw		AIKO-G650-MCH72Mw		AIKO-G655-MCH72Mw		AIKO-G660-MCH72Mw		AIKO-G665-MCH72Mw		AIKO-G670-MCH72Mw	
	STC	NOCT	STC	NOCT	STC	NOCT	STC	NOCT	STC	NOCT	STC	NOCT	STC	NOCT
P _{max} [W]	640	482	645	486	650	490	655	493	660	497	665	501	670	505
V _{oc} [V]	54.20	51.18	54.30	51.28	54.40	51.37	54.50	51.47	54.60	51.56	54.70	51.66	54.80	51.75
V _{mp} [V]	44.90	42.40	45.00	42.50	45.10	42.59	45.20	42.69	45.30	42.78	45.40	42.87	45.50	42.97
I _{sc} [A]	15.00	12.13	15.06	12.18	15.12	12.23	15.18	12.28	15.24	12.32	15.30	12.37	15.36	12.42
I _{mp} [A]	14.26	11.38	14.34	11.44	14.42	11.51	14.50	11.57	14.57	11.63	14.65	11.69	14.73	11.76
Module Efficiency	23.7%		23.9%		24.1%		24.2%		24.4%		24.6%		24.8%	

Product Specification

Cell Type	N-Type ABC
Glass	3.2mm tempered glass
Frame	Anodized aluminum
Cable	4mm ² (IEC) 12AWG(UL) +400mm, -200mm/±1400mm or Customized Length
No. of Cells	144(6*24)
Junction Box	IP68, 3 bypass diodes
Connector	MC4 Compatible/MC4-EVO2A
Weight	27.1kg±3%
Dimension	2382*1134*30mm
Package Detail	36pcs per pallet / 144pcs per 20'GP / 720pcs per 40'HC

Temperature Ratings (STC)

Temperature Coefficient of I _{sc}	+ 0.05%/ °C
Temperature Coefficient of V _{oc}	- 0.22%/ °C
Temperature Coefficient of P _{max}	- 0.26%/ °C

Installation Guide

Operation Temperature	-40°C - +70°C
Maximum Series Fuse Rating	25A
Protection Class	ClassII
V _{oc} and I _{sc} Tolerance	±3%
Maximum System Voltage	DC1500V
Maximum Static Loading	Front 5400Pa Back 2400Pa
Hail Test	40 mm diameter hail at 23 m/s
Fire Rating	IEC Class C



www.aikosolar.com
marketing@aikosolar.com

*AIKO reserves right to update the specification without notice
*Optional Munich Re coverage is available upon request
V4.1_202510_DsDr_EN